

EXISTING ASPHALT PAVEMENT

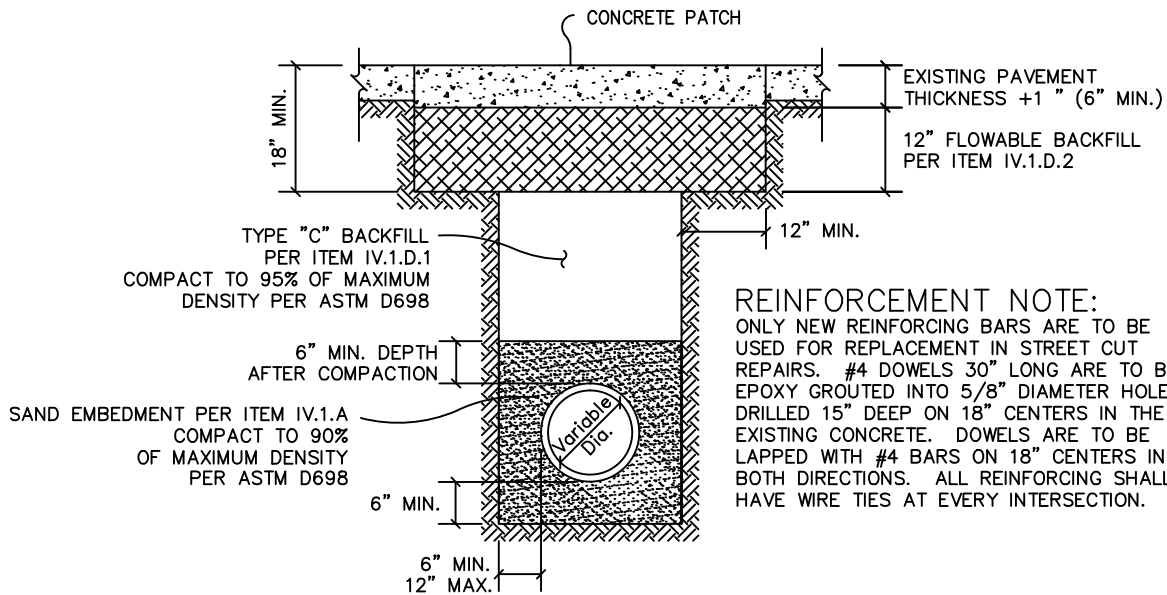

**REINFORCEMENT NOTE:**  
 ONLY NEW REINFORCING BARS ARE TO BE USED FOR REPLACEMENT IN STREET CUT REPAIRS. #4 DOWELS 30" LONG ARE TO BE EPOXY GROUTED INTO 5/8" DIAMETER HOLES DRILLED 15" DEEP ON 18" CENTERS IN THE EXISTING CONCRETE. DOWELS ARE TO BE LAPPED WITH #4 BARS ON 18" CENTERS IN BOTH DIRECTIONS. ALL REINFORCING SHALL HAVE WIRE TIES AT EVERY INTERSECTION.

EXISTING CONCRETE PAVEMENT

**NOTES:**

1. AT THE END OF EACH WORK DAY, ALL SPOILS SHALL BE REMOVED FROM THE TOWN R.O.W. UNLESS PRIOR WRITTEN PERMISSION IS OBTAINED FROM THE TOWN TO STORE SPOILS IN DESIGNATED SPOIL STORAGE AREAS THAT DO NOT OBSTRUCT AUTOMOBILE OR PEDESTRIAN TRAFFIC.
2. ALL PAVEMENT SHALL BE REMOVED ALONG NEAT SAW CUT LINES PER ITEM 8.8.
3. A MAXIMUM OF 300-FT OF OPEN TRENCH WILL BE ALLOWED AT ANY TIME, UNLESS APPROVED BY THE TOWN ENGINEER.
4. MINIMUM COVER SHALL BE 42-INCHES FOR 8" & 12" WATER LINES AND 60-INCHES FOR 16" & LARGER WATER LINES.
5. NATIVE MATERIALS ARE NOT ACCEPTABLE FOR USE IN FLOWABLE BACKFILL MIX.
6. IF GROUND WATER IS ENCOUNTERED THE PIPE EMBEDMENT SHALL BE CRUSHED ROCK GRADE 4 PER ITEM 2.1.8 (a). IN SANDY SOILS THE CRUSHED ROCK EMBEDMENT SHALL BE WRAPPED IN A FILTER FABRIC.
7. ASPHALT TACK COAT MUST BE PLACED ALONG ALL EDGES.

